



**Cornell Village PS, Cornell Northeast and Cornell
Southeast Boundaries**

Little Rouge PS – School Council

February 28, 2011

Welcome and Introductions

- Yvonne West – Principal, Little Rouge PS
- Gilbert Luk – Planner
- Dawn Adams – Manager of Accommodation

Agenda

1. Current Cornell Village PS Boundary
2. Proposed Boundaries
3. Development remaining in Cornell/Little Rouge
4. Proposal
5. Questions?

Current Cornell Village & Little Rouge Boundary and Holding

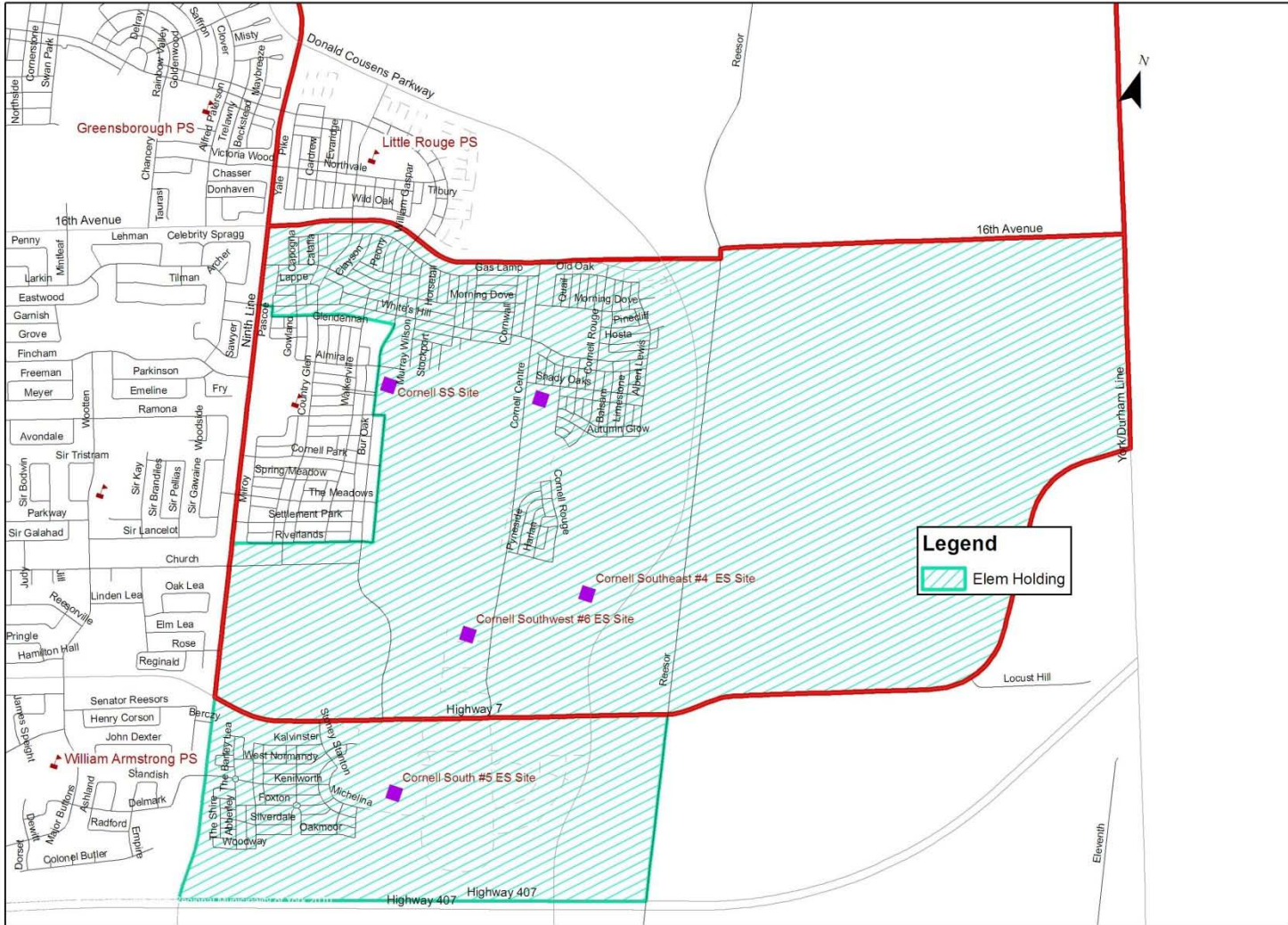

Currently 294 students from Cornell Village PS boundary overflowed to Little Rouge PS

Proposed Boundaries

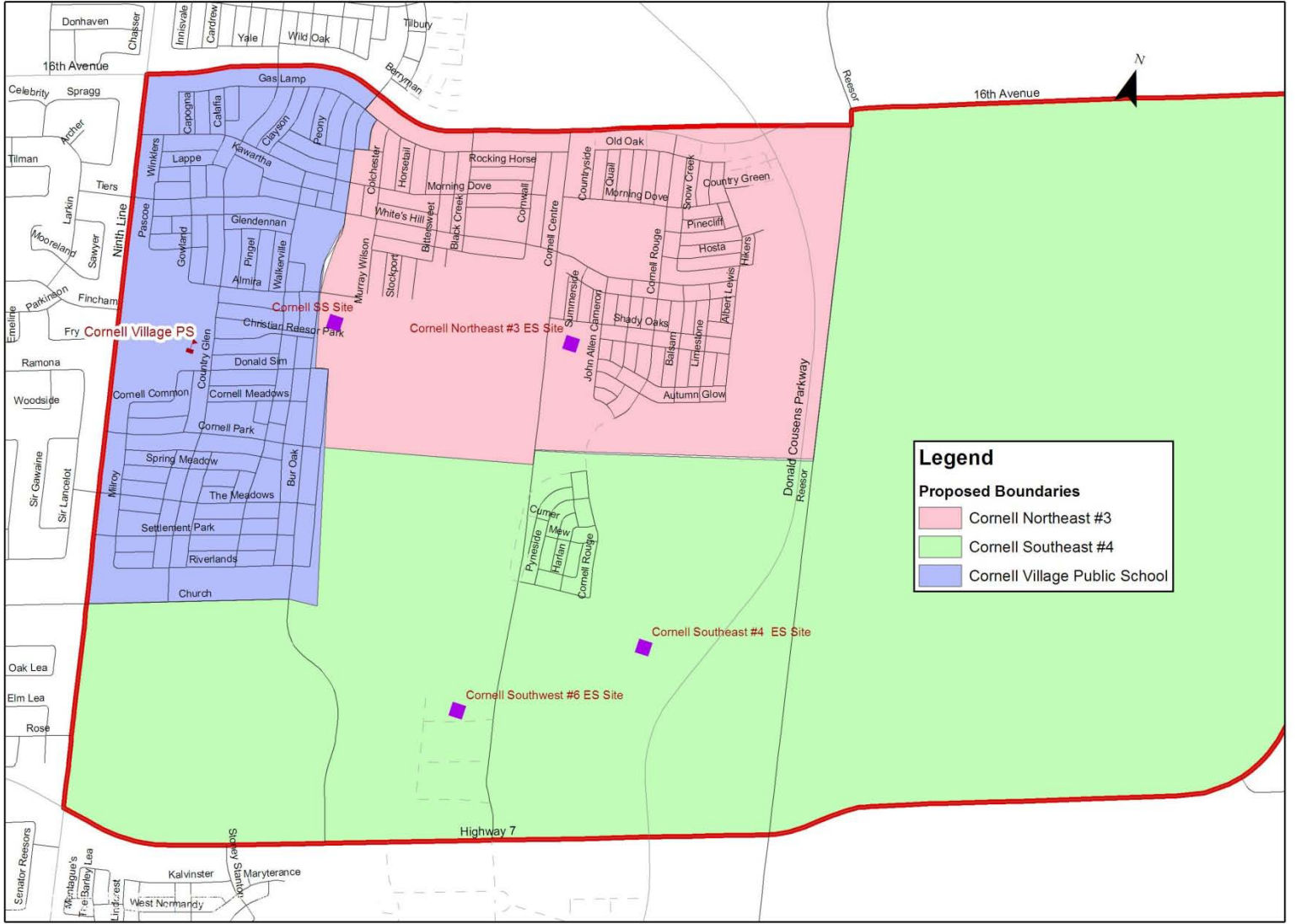

Legend

Proposed Boundaries

- Cornell Northeast #3
- Cornell Southeast #4
- Cornell Village Public School



Development in Little Rouge Boundary/ William Armstrong – Sec B Boundary

- Within the Little Rouge PS boundary, there are approximately 434 units of residential development remaining in submitted development applications
- Currently there are approximately 675 units built within Little Rouge PS boundary
- In William Armstrong – Section B boundary, approximately 539 units have been built
 - There are approximately 4,000 high density units remaining in the boundary in development applications awaiting approval

Cornell Area Development

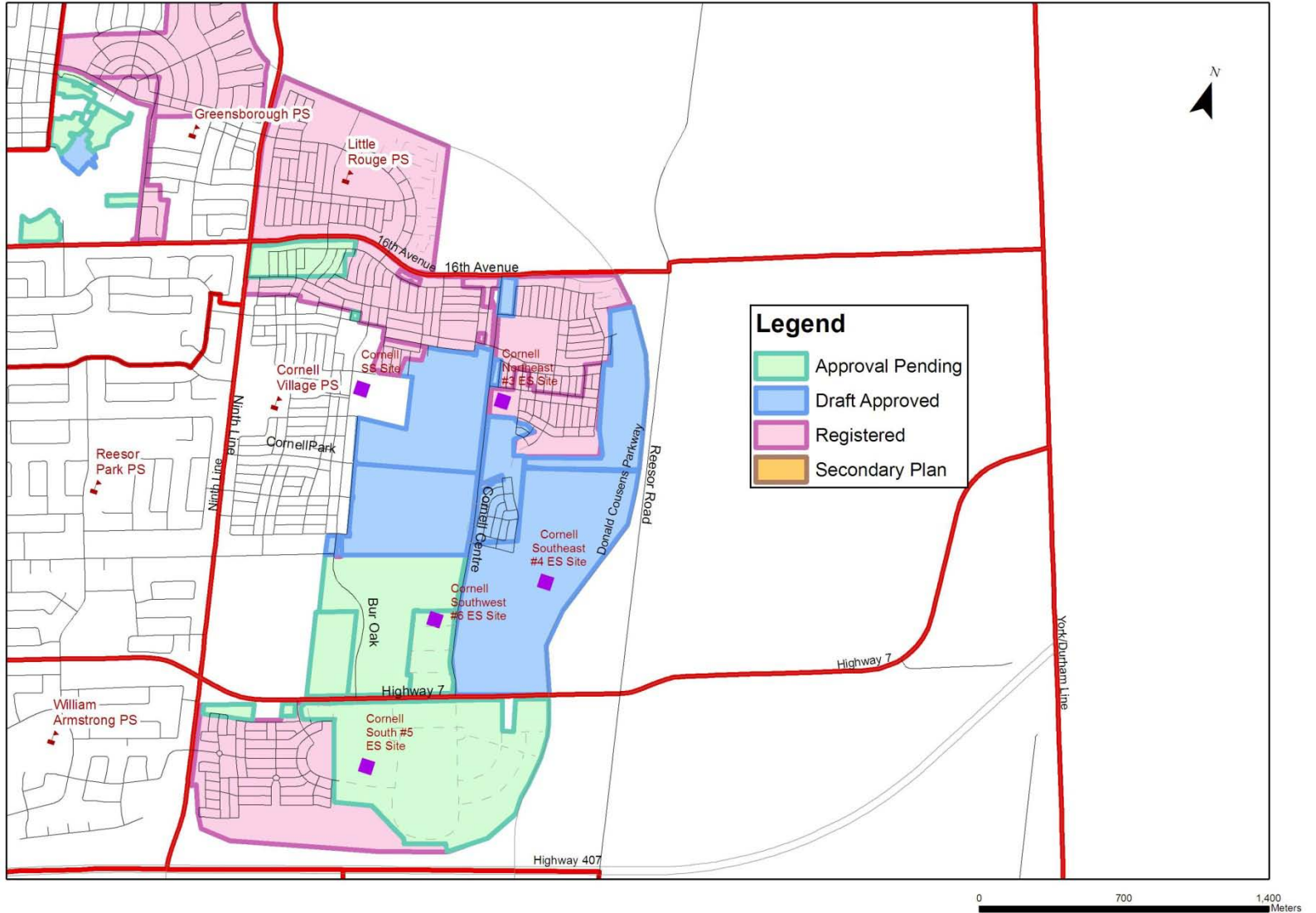

Little Rouge PS Projection with departure of Cornell Village overflow students

Little Rouge PS (includes holding William Armstrong – Sec B)		539 OTG
Year	Nom	FTE
2012	434	388
2013	494	448
2014	544	498
2015	572	526
2016	587	541
2017	637	591
2018	675	629

Implementation

- Cornell Village PS boundary be split into 3 boundaries effective September 2011
- Implementation in September 2012, with all students in Cornell NE and Cornell SE boundaries attending the new Cornell NE school
- Students from within the new Cornell Village PS boundary will attend Cornell Village PS
- Current Grade 6 students who are attending Cornell Village PS and within the new Cornell NE boundary be allowed to stay in 2012 to graduate with their classmates at Cornell Village PS

Implementation

- Students currently in Grade 6 from the Cornell Village PS boundary holding at Little Rouge PS will be given the choice to stay at Little Rouge in 2012 to graduate with their classmates.

Process

- January 17, 2011: Cornell Village School Council Meeting
- February 1, 2011: Public Meeting held at Cornell Village PS
- February 2011: Take recommended boundary change to Programming Planning Committee
- March 2011: Take recommended boundary change to Board Standing and Board for final approval

Questions
