



Boundary Meeting

Nellie McClung PS

November 12, 2013

Introductions

Joel Hertz

Trustee

J. Parappally

Superintendent of Schools

Wendy Thompson

Principal, Nellie McClung PS

Candice Schlosser

Vice Principal, Nellie McClung PS

Dawn Adams

Manager, Accommodation

Planning

Sonja Meehan

Senior Planner

www.yrdsb.ca

Schools > Find a School > Boundaries

[Careers](#) | [Newsroom](#) | [Contact Us](#) | [Feedback](#) | [BWW L](#)

Google™ Custom Search

Search



OUR MISSION

We Unite in Our Purpose to Inspire and Prepare Learners for Life in Our Changing World Community.

Google™ Translate

Home

About Us

Board of Trustees

Schools

Programs & Initiatives

Students

Parents

Community

Find a School

School Locator

New Schools

School Profiles

School Year Calendar

Boundaries

Registration

Maps to our Schools

Enrolment

Schools at a Glance

Child Care and Early Years

Student Transportation

School Permits

School Councils

Read the *Director's Blog*

From the desk of Ken Thurston, Director of Education



@yrdsb

& Events



National Community Safety and Crime Prevention Month
November, 2013



Holocaust Education week
November 3-10, 2013



[Media Literacy Week November 4-8, 2013](#)
November 3-10, 2013



National Housing Day November 22, 2013





OUR MISSION

We Unite in Our Purpose to Inspire and Prepare Learners for Life in Our Changing World Community.

Google™ Custom Search

Search

Google™ Translate

Planning & Property Development Services Home

Elementary Boundaries

Secondary Boundaries

Boundary Review Process & Presentations

School Profiles

Capital Priorities Listing

Active and Safe Routes to School

Archived Boundary Changes

New Schools

Future Schools

Education Development Charges

Education Development Charges By-Law

Boundary Review Process & Presentations

2013/14

School/Boundary	Presentation	Meeting Date(s)	Board Approved
Nellie McClung PS/ Anne Frank PS/ Unnamed Block 11 South		November 12, 2013, 7pm at Nellie McClung PS	
Ventura Park PS FI Julliard PS New Block 18 #2 FI School	Community Meeting ★ Community Meeting ★	May 28, 2013, 7pm at Ventura Park PS June 10, 2013, 7pm at Julliard PS Public Meeting December 4, 2013, 7pm at Ventura Park PS	
Dr. Roberta Bondar PS Unnamed Block 18 North	Community Meeting ★	May 22, 2013, 6:30pm at Dr. Roberta Bondar PS	
Emily Carr SS Tommy Douglas SS (opening Sept. 2014)	School Council ★	May 27, 2013, 7pm at Pierre Berton PS June 3, 2013, 7pm at Pierre Berton PS	June 4, 2013 ★

Other School Accommodation Information

School/Boundary	Presentation	Meeting Date(s)	Board Approved

Agenda

- New School for 2014: Anne Frank PS
- Proposed Elementary School Boundaries
- Elementary Boundary Review Timelines
- Secondary School Attendance

Anne Frank PS

- Scheduled to open September 2014
- South of new park at Ilan Ramon Blvd. and Valley Vista Dr.
- Will offer full day kindergarten and an Active & Safe Routes to School program implementation is also scheduled
- Principal will be appointed in early 2014
- School start and end times will be established in Spring 2014
- New school meeting scheduled for February 11, 2014, 7pm at Nellie McClung PS

ENTIAL RD-3
 17 sq.m. (2.23ha)
 3,543 sq.m. 15.8%
 7,405 sq.m. 33.2%
 11,366 sq.m. 51.0%

REQUIRED	PROVIDED
15m	25.64m
15m	15.41m
15m	45.16m
15m	79.86m

6 STOREYS, ANY AREA, SPRINKLERED

ROOMS + 6 FUTURE CLASSROOMS X 1.5
 C/S INCLUDING 1 BARRIER FREE SPACE
 JOCS 2 BARRIER FREE SPACE

IF
 65M-3985
 N
 PALITY OF YORK
 BY:
 S.

GEOMETRIC
 PAUGHAN
 19
 139.24m

ON BAR
 14
 139.24m
 J ENNETT LTD.
 12

E CHARLES
 10/15
 139.24m
 12

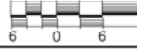
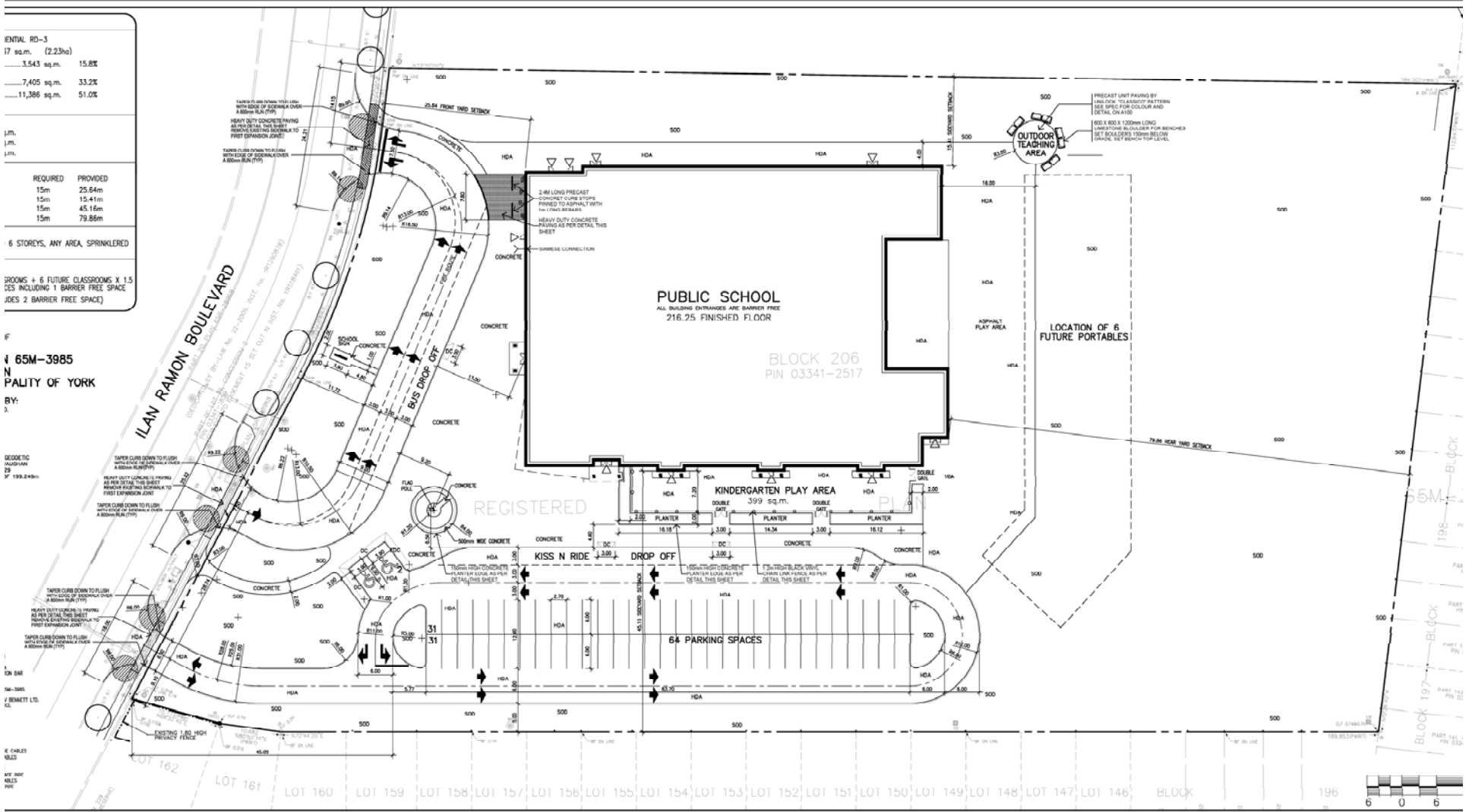

SITI

Establishing a Boundary

- Boundaries are created for long term sustainable enrolment of a school
- Follow major features such as:
 - Hard dividers like roads, railways
 - Natural dividers like rivers, green spaces, etc.
 - Parcels
- Non-transportation zone or 'walkability'
- Future residential development
- Student yields
- Long term student projections

Current Nellie McClung PS Boundary

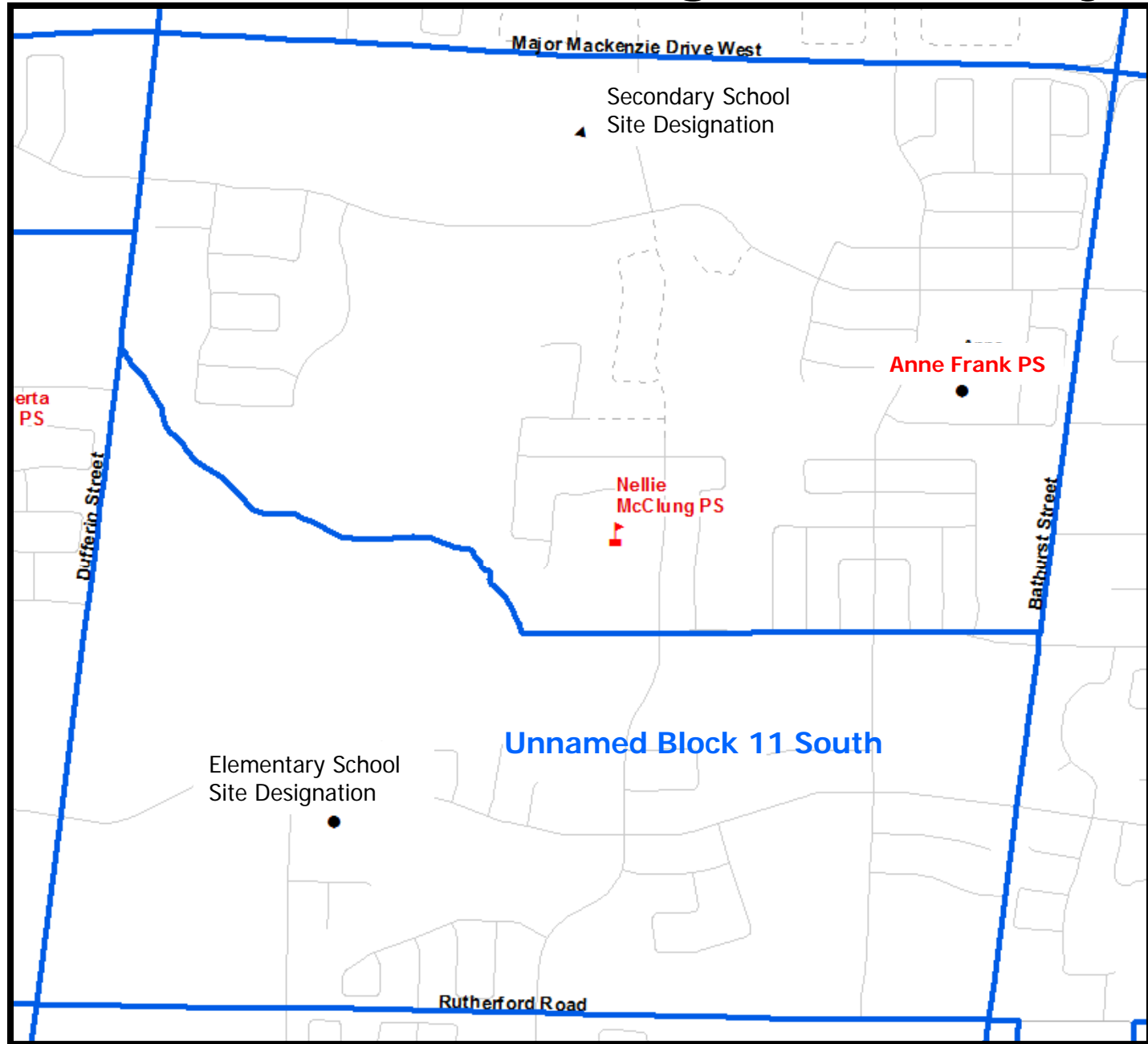

Unnamed Block 11 South

- Two elementary school site designations in Block 11
- The block 11 south boundary was created in 2005
- The north site was chosen to be built as a school because more students could walk to school, and the site is located within a large cluster of students
- This boundary review will eliminate the Block 11 south boundary and have two operating school boundaries
- The third site will be evaluated if needed for future school accommodation

York Region District School Board

Student Distribution Map

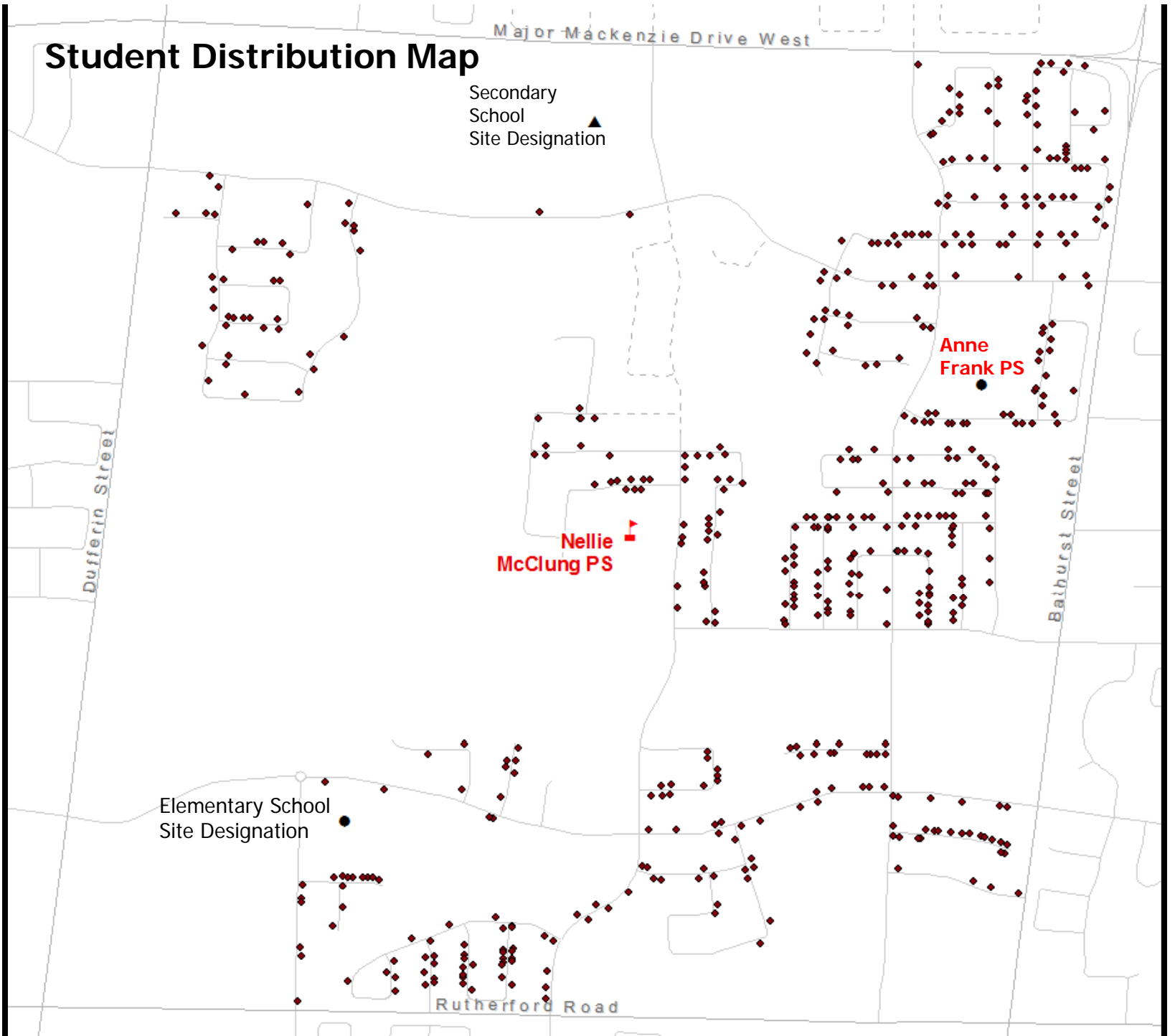

York Region District School Board

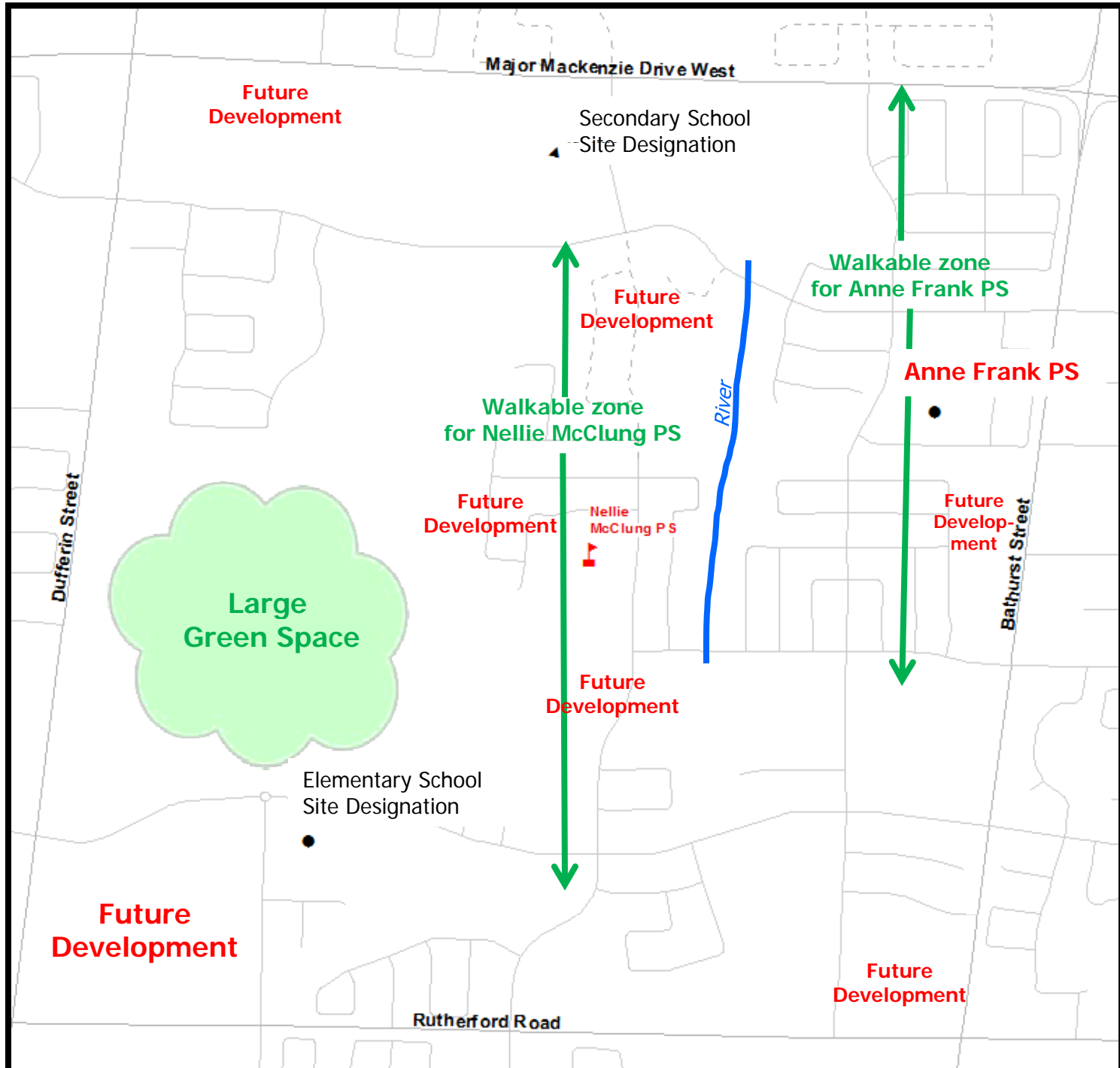

Option 1

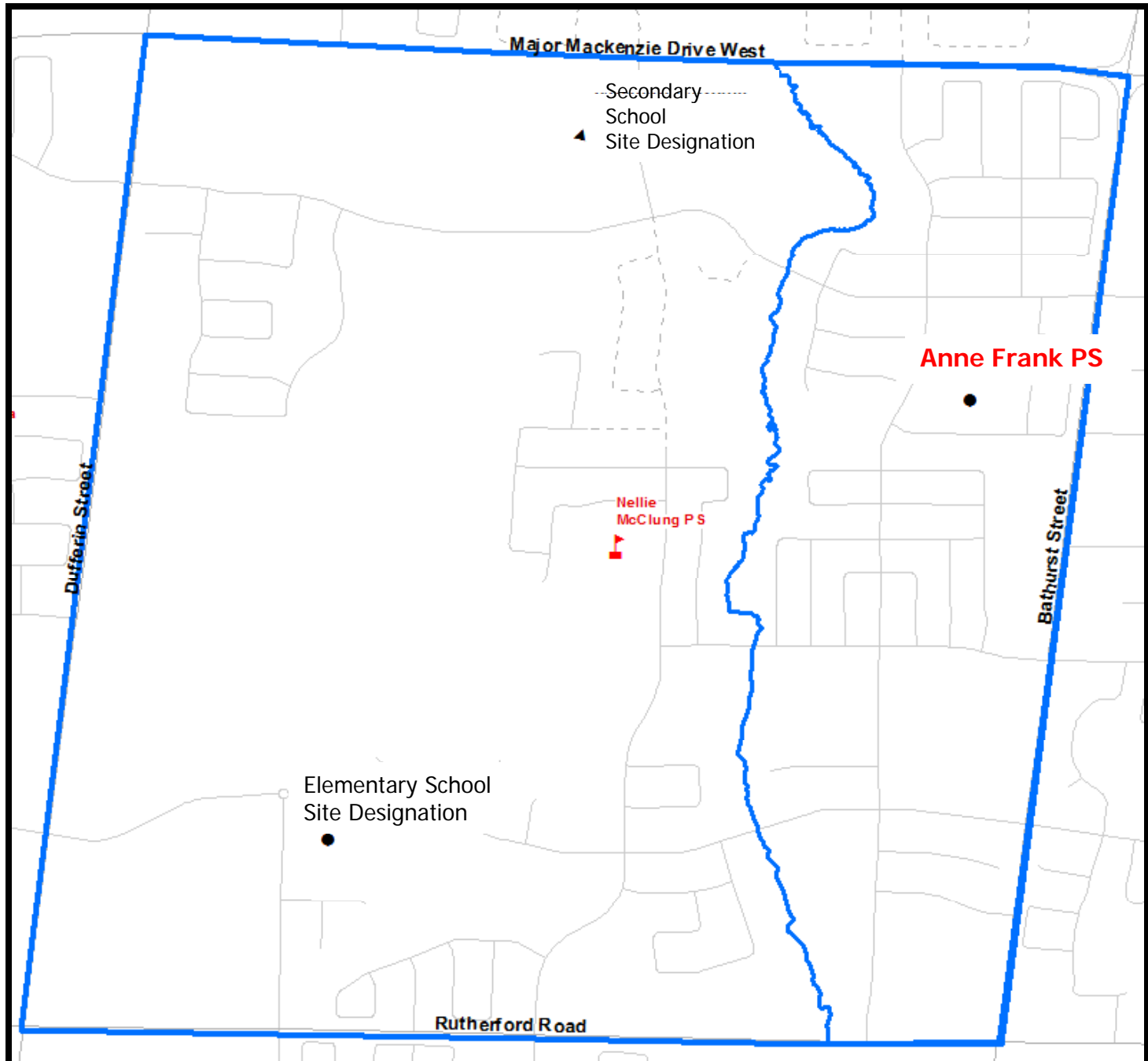

Option 2

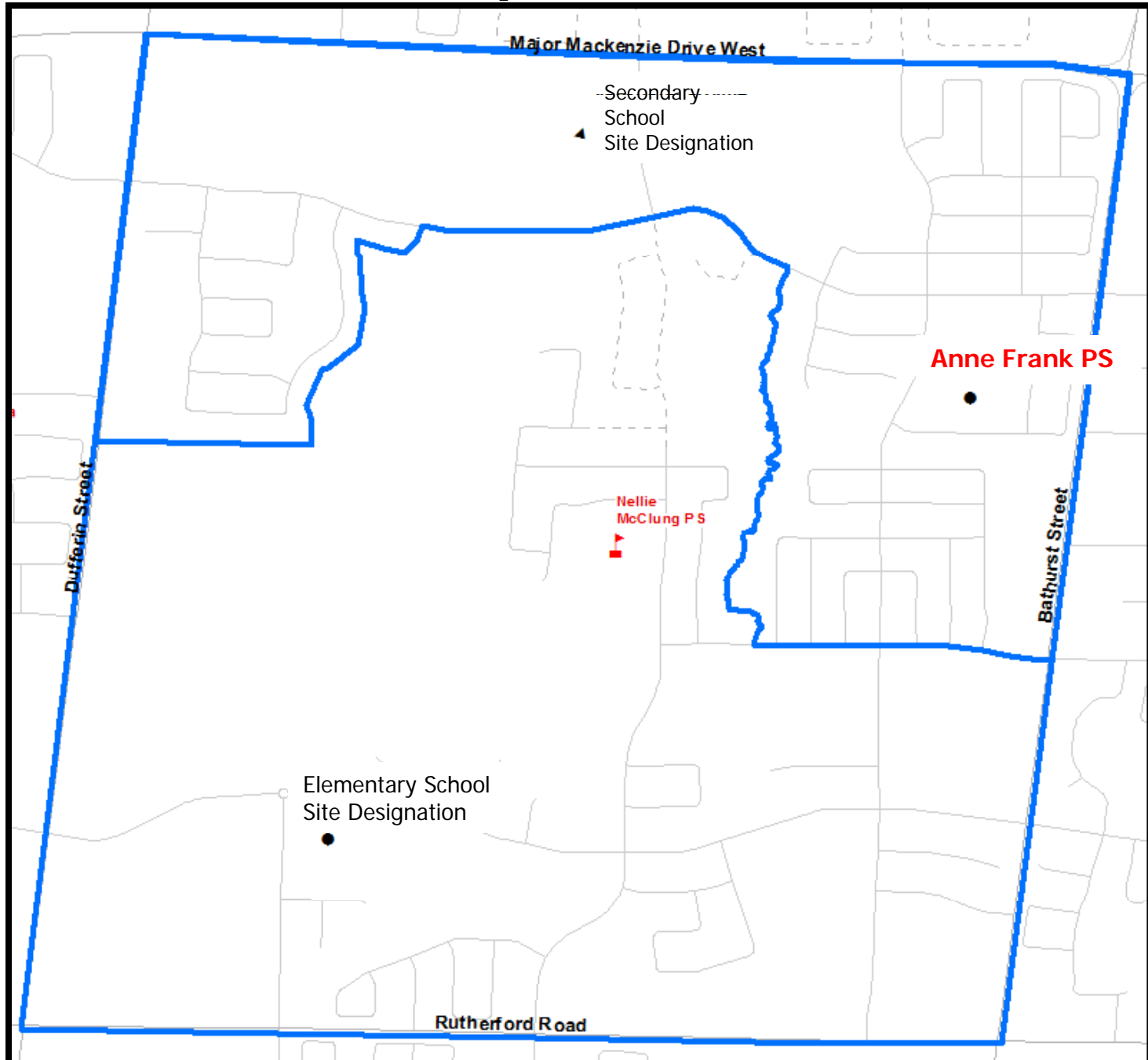

Projected Enrolment for Option 2

Year	Nellie McClung PS 603 Ministry Rated Capacity	Anne Frank PS 615 Ministry Rated Capacity
2014	319 + approx. 4 classes FI = 411	454
2019	547	575
2023	709	621

New Elementary Boundary

- Staff will be recommending Option 2 as the preferred option to the Board
- Option 2 is preferred due to:
 - Long term enrolment stability for community
 - Balance of projected school enrolments in the long term
 - More of a balanced mix of different types of housing units due to differing pupil yields

Elementary Boundary Review Timelines

Public Meeting	November 12, 2013
Property Management Committee	January 2014
Coordinating Council of Superintendents	Late January/early February 2014
Board Standing (delegation opportunity)	February 18, 2014
Board	March 4, 2014
Implementation	September 2014

Secondary School Attendance

New School Planning

- There are three requirements to proceed with a new school project
 - 1. Land**
 - The Board has a secondary school site designation in Block 11 for future school need
 - We do not own this land at this time
 - We do have an option to purchase this site if required

New School Planning

2. Students

- Students need to be attending existing public secondary schools in the surrounding area
- Cannot 'bank' on future students in lower elementary grades or students from other Boards/private schools

New School Planning

3. Funding from the Ministry of Education

- This is achieved by creating a business case to show we have little/no accommodation options for existing students in the surrounding area
- A substantial number of students for potential new school need to be accommodated in holding locations or portables
- Submissions are for specific school year openings
- New school funding is decreasing across the province

Current Secondary School Boundaries

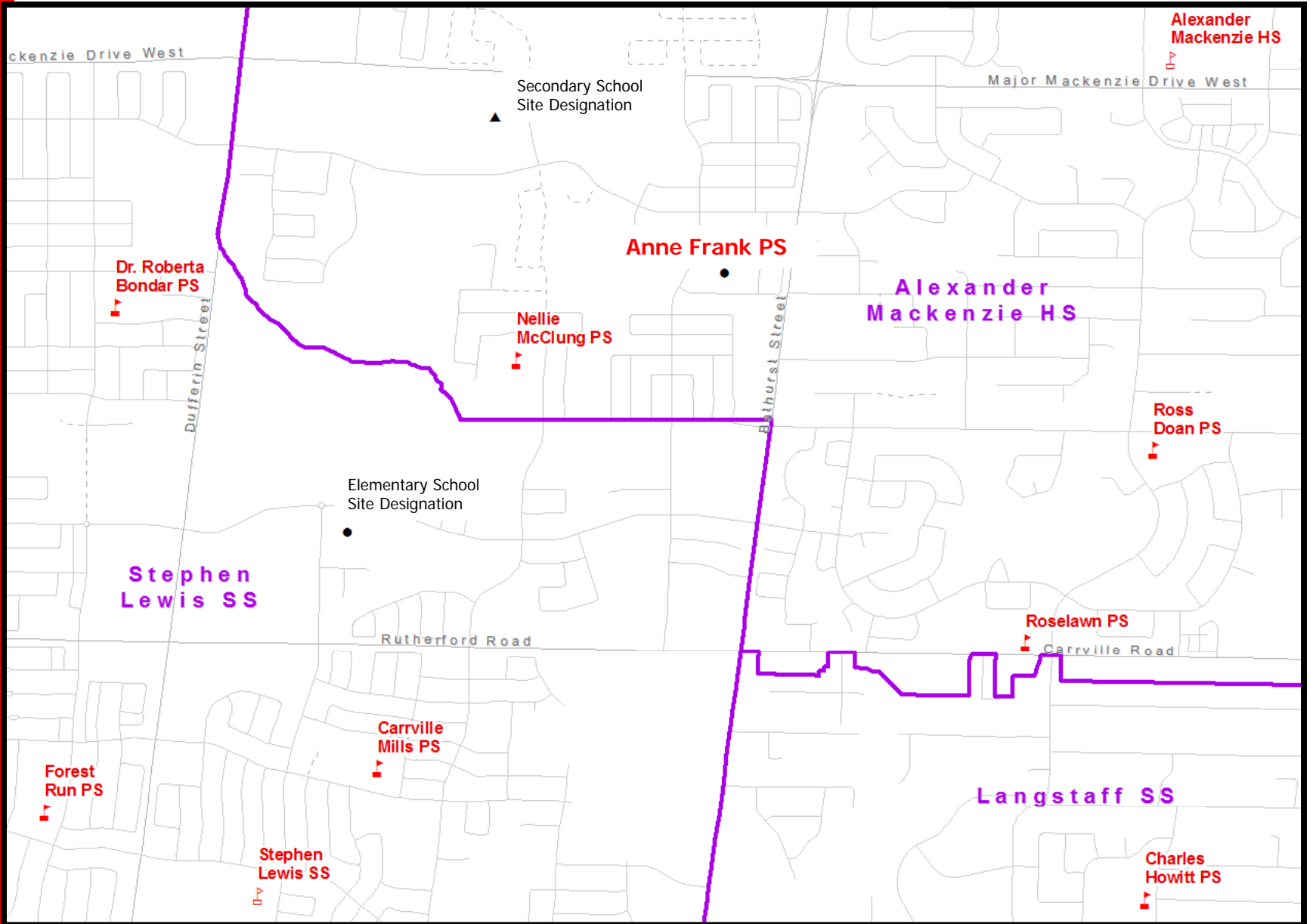

Secondary School Holding Area

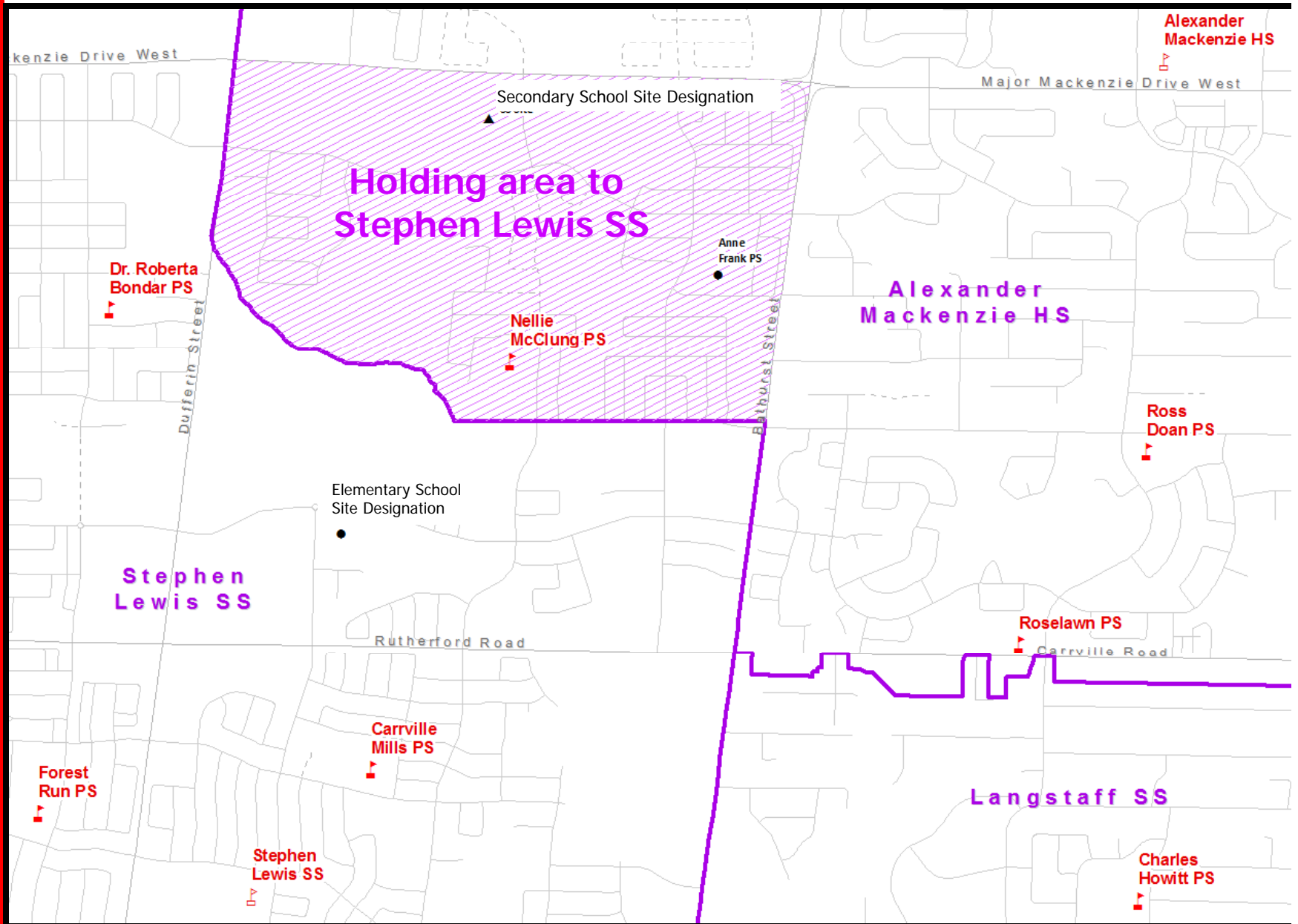

Building a Case

- By increasing enrolment at Stephen Lewis SS, we are taking the first step in building a business case
- The business case will take many years as there is capacity at Alexander Mackenzie HS
- Our Board has submitted a business case to the Ministry three times for a new secondary school in Markham for September 2017
- No other new secondary schools will be approved prior to that timeframe

Questions?

